

630

Dr. Debi Prasad Mondal, Marich
28/12/85
89607 (500 + 300 + 750 + 200 + 10)

Stamp Clear



Stamp for registration
1.00 P.M. on the 15th
day of April
1989 at the Dist
Registration Office by
Debi Prasad Mondal
of the

1) Debi Prasad Mondal
of Burdwan District Burdwan
by estate Khindoo by profession
Doctor
2) Bishhalakshya Babu
of Purdang Kshya Babu
of Burdwan P.S.

x Debi Prasad Mondal

[Signature]

and as agent for Satraja
-kshya Babu, Shovanakshya
Babu, Manojakshya Babu,
Anujakshya Babu
Under a power of attorney
No-51 for 186 Authenticated
by the R.A. Cal + also
Arunakshya Babu under
a power of attorney NO
51 for 186

22/5/89 15/4/89

x Debi Prasad Mondal

Bishhalakshya Babu
for self + as agent for
Anujakshya Babu
Shobhonakshya Babu
Anongirakshya Babu
Anujakshya Babu
Anujakshya Babu
Nipalakashya Babu
Sun. Mahamaya Babu
Sailajaakshya Babu
Sun. Gayachace Mitra
Sun. Gayanti Mitra

-50 for 186 authenticated
by the R.A. Cal + also
Utpalakshya Babu under
a power of attorney No-597 for 186
authenticated by R.A. Cal +
also Mahamaya Babu
under a power of attorney
No-5 for 1987 authenti-
cated by the A.D.S.R,
Burdwan + also Sailaja-
kshya Babu under a power
of attorney No-193 for 172
authenticated by the S.R. Cal + also

22/5/89

15/4/89

[Signature]

630
 Dr. D. Prasad Mondol, Naricha
 26/12/88
 8964 (500 + 300 + 750 + 200 + 10)

Stamp Clerk
 Collector

Amitaksha Das
 as agent for
 Ambujaksha Das

2/25/



18/1/89

Jayasree Mohan + Jayanti Mitra
 under a power of attorney No-185
 authenticated by the R.A. Calcutta
 3) Amitaksha Babu S/O Ambujaksha
 Babu of Burdwan Shamastt Burdwan
 by caste Hindu by profession service
 as agent for Ambujaksha Babu
 under a power of attorney No-307
 for 183 authenticated by the R.A. Cal

Krishna Kanti Bhuj

BY Krishna Kanti Bhuj
 S/O Mr. Rabinchandra Bhuj
 of Burdwan THANA
 DISTRICT-BURDWAN
 BY CASTE Hindu
 BY PROFESSION Dealer

15/4/89

Section 7 (2) of I. R. Act
 BURDWAN

630

Dr. Jai Prasad Mondal, Noida

26/12/88
89607 (500 + 300 + 750 + 200 + 10)

Stamp
Stamp Clerk
26/12



15/1/89

15/1/89



630

Dr. Delhi Prasad Mondel, Narich
26/12/88
896 of (500 + 300 + 750 + 200 + 10)

26/12
Stamp
Collector



Stamp
Collector

15/1/89

Handed

630

Dr. Debi Prasad Mondal - Narail

26/12/88

89607 (500 + 300 + 750 + 200 + 10)

[Handwritten signature]

Stamp: District Collector



Stamp: District Collector, Narail

18/1/89



RECEIVED
FBI - NEW YORK

10/14/83

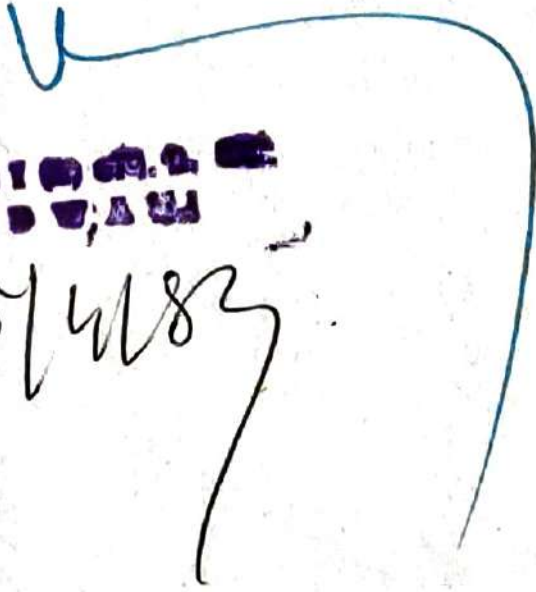



OFFICE OF THE ENGINEER
BANGALORE

15/4/83



THE DISTRICT OF COLUMBIA
OFFICE OF THE ARCHITECT OF THE CAPITAL

15/11/83



THE ASSOCIATED...

15/6/89



John O. 253

Inv. No.	52
Volume No.	196
Page No.	8787
Year	1988
...	89

Red handwritten signature

The land of Sebi Prasad Mandal coloured Blue in this plan of plot No. 797
 & Khaja Anower Ber Jh. No. 36. Kh. No. 172 P.S. & Dist. Burdwan is being exchanged
 with the land of Bishalaksha Basu & others coloured Red in this plan of plot No. 420
 Mouza Radhanagar J.L. No. 39 Kh. No. 34. P.S. & Dist. Burdwan. Ori Sireul.

MOUZA. RADHANAGAR J.L. NO. 39
 P.S. & DIST. BURDWAN
 SCALE: - 33' = 1 INCH.

N. BASU ROAD → T.O.G.T. ROAD

MOUZA. KHAJAANOWER BER Jh. NO. 36
 P.S. & DIST. BURDWAN.
 SCALE: - 33' = 1 INCH.

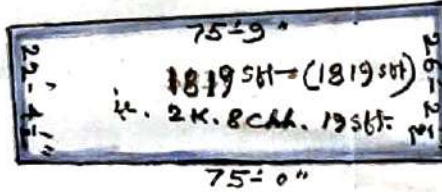
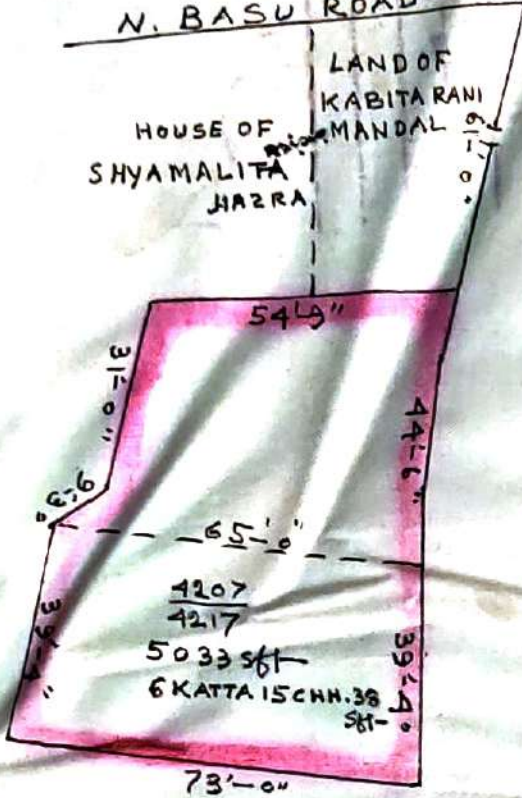

SIGNATURE OF 2nd PARTY.

Sarojakesha Basu ✓ Sarojakesha Basu ✓

Amritajalsra Basu

Shobhanarajy Basu

Amritakesha Basu

Monsjakesha Basu

Jyotsna Mitra

Sailjakesha Basu

Jayanti Mitra

Utpalakesha Basu

Nishalesha Basu

ब्रशब्रश यत्र
Arnakita Basu

SIGNATURE OF 1st PARTY.

Sebi Prasad Mandal



Drawn by
 R.N. Gaiswas.
 Burdwan.

Handwritten text at the top left, possibly a header or address, including the number '2012'.

Handwritten text at the top right, including the number '190'.

Handwritten signature or name in black ink, appearing to be 'S. S. S.'.

Vertical text on the left side of the page, possibly a date or reference number.

Text enclosed in a blue rectangular box, possibly a stamp or official marking.



Handwritten text in the middle section, possibly a signature or name.

Handwritten text in the lower middle section, possibly a signature or name.



Large handwritten signature or name in blue ink at the bottom right.